

### FEATURES

- A** Digital sensor input
- B** Uplink port
- C** On-board temperature & humidity sensor  
Operating range: -40°C to 85°C
- D** Temperature sensor inputs

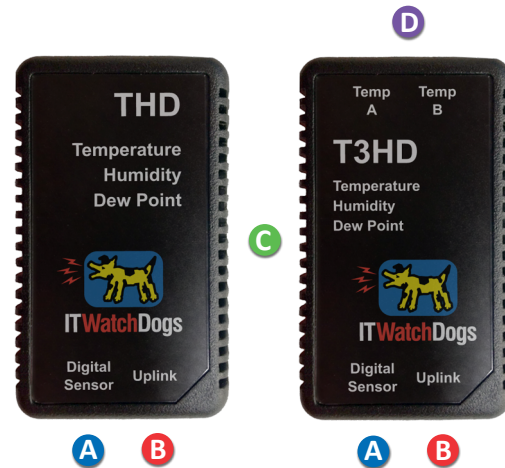

### KIT INCLUDES

THD
THD Sensor
6P6C Modular Patch Cable (10ft or 50ft)

T3HD
T3HD Sensor
6P6C Modular Patch Cable (10ft or 50ft)
Remote Temp Sensor (3ft cable)
Remote Temp Sensor (6ft cable)

### DESCRIPTION

The THD/T3HD Sensors provide real-time temperature, humidity and dew point data back to the host unit for data logging and alarming. These sensors can be daisy chained using the digital sensor input, or another sensor can be added to this port. The THD and T3HD sensors are the same with the T3HD having two additional ports for adding temperature sensors. THD/T3HD sensors are connected to host unit with provided 6P6C patch cable using the uplink port. The enclosure is designed for easy mounting nearly anywhere using screws or adhesive.

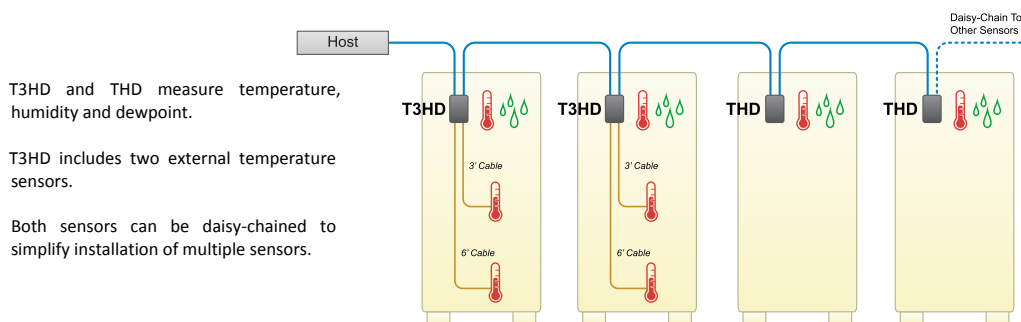

## DIMENSIONS

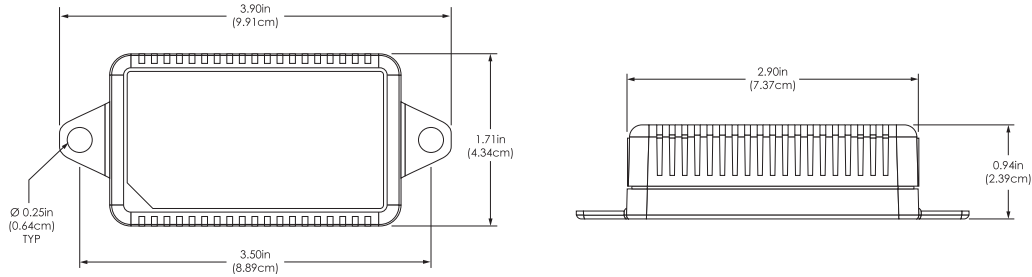

## SPECIFICATIONS

Environmental	
Temperature	
Range	-40 to 85°C
Accuracy (typical)	± 0.3°C
Accuracy (minimum)	see graph
Relative Humidity	
Range	0 to 100% RH
Accuracy (typical)	± 2.0% RH
Accuracy (minimum)	see graph
<i>Note: THD/T3HD sensors are pre-calibrated by the manufacturer</i>	
Physical Dimensions	
Width	3.90" (9.91cm)
Length	1.71" (4.34cm)
Depth	0.94" (2.39cm)
T3HD Weight	1.2oz (34.0g)
THD Weight	1.1oz (31.2g)
Approvals	
Compliance	RoHS

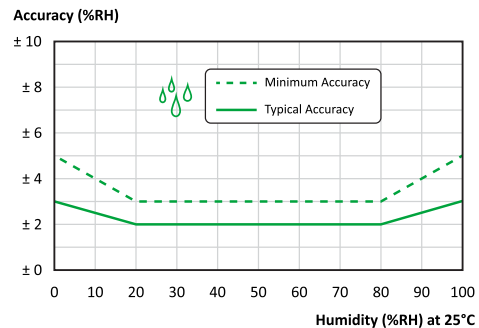
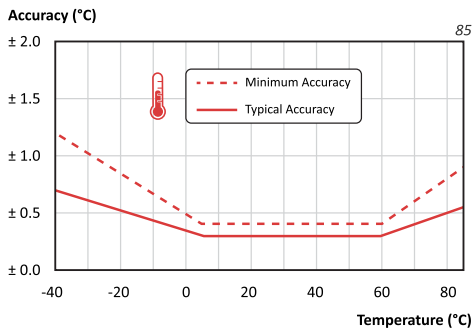

## WARRANTY

ITWatchDogs warrants that T3HD/THD sensors will be free of defects for 1 year from the date of purchase.